

- Legend**
- Site Boundary
  - Release Boundary
  - Road Access
  - Drainage / Pedestrian Linkage
- Road**
- Laneway
  - Footpath
  - Indented Parking Bays
  - Single Driveway with Possible Double
  - Double Driveway
- Allotment Details**
- Indicative Private Open Space Location
  - Indicative Alternative Private Open Space Location
  - Maximum Building Location Envelope
  - Mandatory Built to Boundary Wall
  - Optional Built to Boundary Wall
  - Preferred Garage Location (on Single Family Dwellings)
  - Preferred Garage Location (Double permitted on 2 Storey Dwelling)

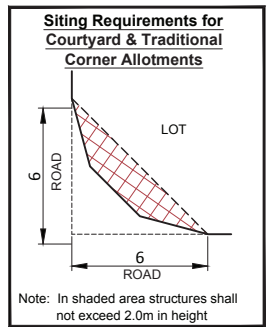

Plan of Development Table	Terrace (Mews) Allotments L6, L7.5, L8, L10		Villa Allotments 10m		Premium Villa Allotments 12.5m		Courtyard Allotments 15m		Traditional Allotments 18m	
	Ground Floor	First Floor	Ground Floor	First Floor	Ground Floor	First Floor	Ground Floor	First Floor	Ground Floor	First Floor
<b>Front Setback</b>										
Primary Frontage	3.0m	3.0m	3.0m	3.0m	3.0m	3.0m	3.0m	3.0m	3.0m	3.0m
Garage	n/a	n/a	4.5m #	n/a	4.5m #	n/a	4.5m #	n/a	4.5m #	n/a
<b>Side Setback</b>										
Built to Boundary	0.025m*	0.025m*	0.2m-0.3m	n/a	0.2m-0.3m	n/a	0.2m-0.3m	n/a	0.2m-0.3m	n/a
Non Built to Boundary (incl. adjoining a laneway)	1.0m	1.0m	1.0m	1.0m	1.0m	1.0m	1.5m	2.0m	2.0m	2.0m
Garage (where accessed directly from a laneway)	0.5m	n/a	0.5m	n/a	0.5m	n/a	0.5m	n/a	0.5m	n/a
Corner Lots - Secondary Frontage	2.0m	2.0m	2.0m	2.0m	2.0m	2.0m	2.0m	2.0m	2.0m	2.0m
<b>Rear Setback</b>										
Rear	n/a	n/a	1.5m	2.0m	1.5m	2.0m	1.5m	2.0m	1.5m	2.0m
Rear (from laneway boundary)	0.5m	0.5m	n/a	n/a	n/a	n/a	n/a	n/a	n/a	n/a
Garage (from laneway boundary)	0.5m	n/a	n/a	n/a	n/a	n/a	n/a	n/a	n/a	n/a
<b>Other Requirements</b>										
On site parking requirements (minimum)	One covered and enclosed space		One covered and enclosed space		Two spaces (one enclosed space)		Two space (one enclosed space)		Two space (one enclosed space)	
Garage location	Single, tandem or double garage acceptable		Single, tandem or double garage acceptable		Single, tandem or double garage acceptable		Single, tandem or double garage acceptable		Single, tandem or double garage acceptable	
<b>Note</b>	* Built to boundary walls are mandatory where shown on plan. The 0.025m setback applies to the concrete slab/footing as well as the external wall. # For home with single or tandem garage, the garage setback is 5.5m									

Acoustically affected lots shaded Green Stage 10. Level One Required

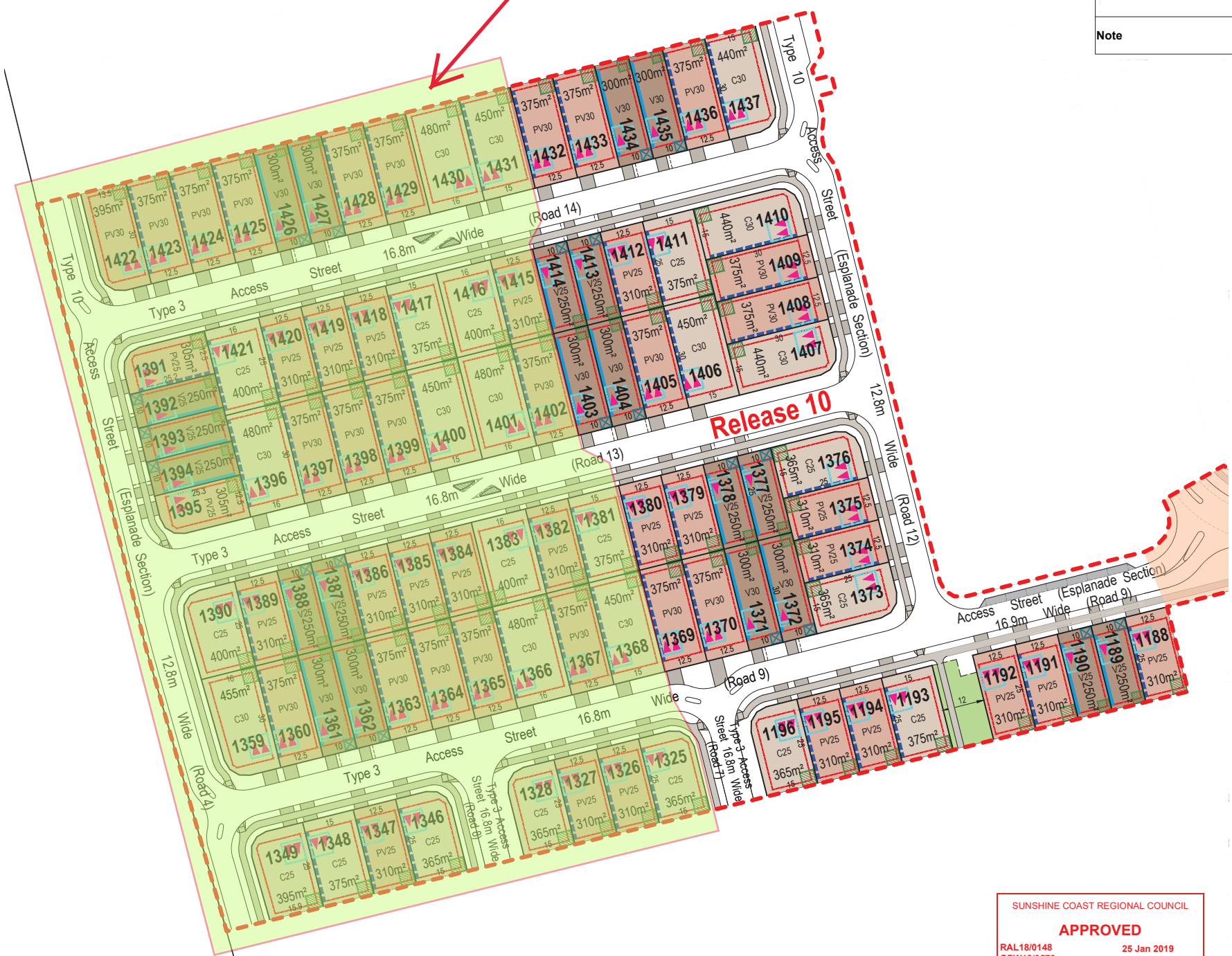

**Plan of Development Notes:**

- General**
- All development is to be undertaken in accordance with the Development Approval.
  - The maximum building height shall be:
    - 8.5 metres for a dwelling house;
    - 11 metres for Multiple Residential (Dual Occupancy).
  - The criteria set out on this approved Plan of Development are "alternative requirements for accepted development" for a Dwelling House. Compliance with these alternative requirements for accepted development will be deemed to represent compliance with the comparable provisions of the Dwelling house code.
- Setbacks**
- Setbacks are as per the Plan of Development Table unless otherwise specified below.
  - Maximum building location envelopes are subject to existing and future proposed easements and/or underground services.
  - Boundary setbacks are measured to the building wall.
  - Eaves (except on a wall that is built to the boundary) must not encroach within 550mm of the side or rear boundaries. Gutters may not extend beyond the boundaries of the lot.
  - The location of the built to boundary walls are indicated on the Plan of Development. Where built to boundary walls are not adopted side setbacks shall be in accordance with the Plan of Development Table.
  - Site Cover - Maximum site cover as per Lot size below:
    - The site cover for lots less than 200m<sup>2</sup> must be in accordance with the approved setbacks and private open space provisions.
    - 200m<sup>2</sup> - 400m<sup>2</sup> - 70%
    - 401m<sup>2</sup> - 600m<sup>2</sup> - 60%
    - Greater than 600m<sup>2</sup> - 50%
  - For the purposes of determining setbacks, a corner lot is a lot that adjoins the intersection of two streets. This does not apply to lots that adjoin a laneway, shared access driveway, bio-retention zone or pedestrian linkage.
  - On courtyard corner lots, a corner truncation setback applies (refer siting requirement diagram). On all other lots the setback to a corner truncation (including where a lot adjoins a laneway) is the same as the secondary street setback (or side setback where adjoining a laneway).
  - Entrance portico may be located closer to the property boundary than stated in the allotment setbacks table, provided that the portico is located not less than two (2) metres from the front property boundary, the height of the portico does not exceed 4.5 metres, the portico remains open and not enclosed and the width of the portico is limited to the front entry area only.
  - Balconies, verandas or equivalent may extend up to one (1) metre into the front setback area and the side street setback area for corner lots, provided they remain open and not enclosed.
  - Garages must not project forward of the front building wall.
  - It is the owners, builders and building certifier's responsibility to ensure compliance with relevant building standards in relation to common built to boundary walls with respect to termite protection, water proofing and drainage to ensure no external impact to neighbouring properties.
- Parking and Driveways**
- Other than where accessed from a laneway, the maximum width of a driveway as it crosses the street verge and the front allotment boundary is: 4 metres for a double garage, and 3 metres for a single garage.
  - There is to be a maximum of one driveway per dwelling.
  - Lot frontages less than 12.5m wide are only permitted to have double garages where they are double storey, unless garage is accessed from a laneway.

- Driveway locations identified on plan are mandatory. Any Relocation of a driveway, which requires the removal of a street trees must provide the replacement of a tree of the same or similar.
  - Lot with alternative garage location shown on the plan can either be built on preferred garage location or alternative garage location
- Private Open Space**
- Private Open Space is provided:
    - On lots 300m<sup>2</sup> or less, the Primary Private Open Space for each dwelling or unit must:
      - Have a minimum area of 9m<sup>2</sup> with no dimension less than three (3) metres;
      - If co-located with a covered outdoor living space, the private open space must include an area open to the sky with a minimum dimension of 1.5m and an overall area of 9m<sup>2</sup> (open to sky);
      - Where relevant, the Primary Open Space should be provided at a mid-block location to ensure adequate light and ventilation penetrates into internal habitable areas.
      - The private open space must be directly accessible from a habitable room.
    - Lots 300m<sup>2</sup> or less which co-locate their Primary Open Space with covered outdoor living space must also:
      - Identify an 'Alternative Private Open Space Location';
      - The Alternative Private Open Space Location can generally be located along the primary frontage or side frontage in the case of a corner lot;
      - 'Alternative Private Open Spaces' must have a minimum area of 9m<sup>2</sup> with no dimension less than three (3) metres.
    - On lots greater than 300m<sup>2</sup>, the private open space must be open to the sky with an area of 16m<sup>2</sup> and no dimension less than three (3) metres.
    - All private open space areas must:
      - Exclude rainwater tanks unless underground;
      - Not be shared with rubbish storage or clothes drying area or mechanical ventilation and not be visible from the street.
- Privacy and Overlooking**
- Buildings must be sited and designed to provide adequate visual privacy for neighbours:
    - Where the distance separating a window or balcony of an adjoining dwelling from the side or rear boundary is less than 1.5m:
      - a permanent window and a balcony has a window/balcony screen extending across the line of sight from the sill to at least 1.5m above the adjacent floor level; or
      - a window has a sill height more than 1.5m above the adjacent floor level; or
      - a window has obscure glazing below 1.5m; where a window, balcony and a window/balcony screen has the same meaning as it does in the Queensland Development Code.
- Requests for minor variations**
- Requests for approval of minor variations to the approved Plan of Development for individual lots to suit site specific conditions are to be assessed by Council as a request for consideration as 'generally in accordance' and accompanied by the relevant Council application fee.

SUNSHINE COAST REGIONAL COUNCIL  
**APPROVED**  
RAL18/0148  
OPW18/0576  
25 Jan 2019

REVISION  
A: 31/08/18 Amend Lots 1407-1410 & 1391-1395  
B: 18/09/18 Amend POD Notes  
C: 15/11/18 Added Speed Controls (Roads 13 & 14)  
D: 21/11/18 Amend Lots around Speed Controls

**Note:**  
All Lot Numbers, Dimensions and Areas are approximate only, and are subject to survey and Council approval.  
The boundaries shown on this plan should not be used for final detailed engineers design.  
**Source Information:**  
Site boundaries: RPS Survey.  
Adjoining information: DCDB.  
Aerial photography: Neamap.  
Environment constraints: SCRC Flood: SCRC

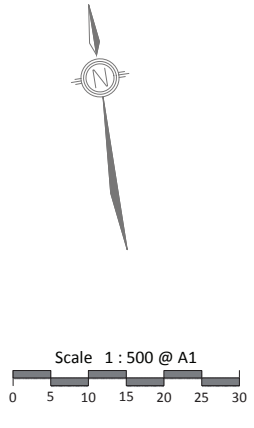

CLIENT **AVID** Property Group

PROJECT **harmony**

Plan of Development  
Neighbourhood 3  
Release 10  
Allotment Layout

Date:	21 November 2018
Comp By:	WNW / JC / MJC
Checked By:	FK
DWG Name:	22470-Rel 10 Application
Job Ref:	22470
Local Authority:	SUNSHINE COAST REGIONAL COUNCIL
Locality:	PALMVIEW
Scale:	1:750
Sheet:	A1
Plan Ref:	22470 - 479
Rev:	D

**RPS**

RPS Australia East Pty Ltd  
ACN 140 292 762  
ABN 44 140 292 762

**Urban Design**  
Brisbane Design Studio  
455 Brunswick Street  
Fortitude Valley QLD 4006  
T +61 7 3124 9300  
F +61 7 3124 9399  
W rpsgroup.com.au

© COPYRIGHT PROTECTS THIS PLAN  
Unauthorised reproduction or amendment  
not permitted. Please contact the author.